

PC

Parts Catalog

John Deere Electric 90 Mower

PC-1279





John Deere Electric 90 Mower
 1972 Model-Serial No. (1001-10,000)
 1973 Model-Serial No. (10,001-11,704)
 1974 Model-Serial No. (11,705-)

(Specifications and design subject to change without notice)

AN EXPLANATION OF CHANGE INDICATOR LINE

New and revised information is identified by vertical lines marked in the left-hand margin of revised pages. These lines indicate changes affecting the ordering of parts.

AN EXPLANATION OF SERIAL NUMBER INFORMATION

Serial number information is listed parenthetically to show on which machines each part can be used. These listings are explained by the following examples.

- (-) The part can be used on all machines.
- (000000-) The part can be used on all machines beginning with the serial number listed.
- (-000000) The part can be used on all machines up to and including serial number listed.
- (000000-000000) The part can be used on all machines between and including the serial numbers listed.

Where XXXXXX's are listed in place of a serial number it indicates a serial number change was made but the exact serial number had not been established when the catalog went to press.

EXPLANATION OF PARTS LISTED AS "SERVICE ONLY"

Certain parts in this catalog are listed in the description column as "Service Only." These parts serve as a replacement or additional part for service instead of the part originally furnished. The serial numbers shown list the machines on which the "Service Only" part may be used.

ALPHABETICAL INDEX

	Page		Page
A		L	
Axle, front	11	Lever, lift	10
Axle, rear	14	Lever, shift	9
B		Lift stop	10
Battery	18	M	
Belt, traction drive	5,6	Main wiring harness	21,22,23
Blades	25,26	Motor, mower	25,26
Box, battery	3	Motor, traction	24
Brake	7,8	Mower deck	16
C		P	
Cables, battery	18	Panel, control	4
Cable, lift	10	R	
Charger, battery	19,20	Resistor	21,22,23
Clutch	5,6	Reverse idler	14
Console	3	Rod, lift lever adjusting	10
Control panel	4	Rods, shifter	15
Countershaft gears	15	Rollers, mower	16
Cover, battery	18	S	
Cover, contactors	4	Seat	4
D		Shaft, input	13
Deck, mower	16	Sheave, drive and driven	5,6,24
Differential	14	Shift lever	9
Diode	21,22,23	Shift lever housing	9
Drive sheave, traction	5,24	Shifter forks	15
Driven sheave, traction	5,6	Shifter rods	15
F		Shroud	4
Forks, shifter	15	Solenoids	21,22,23
Frame	3	Steering gear	11
Fuse	21,22,23	Steering wheel	11
G		Switch, main	21,22,23
Gear case, transaxle	13	Switch, mower	21,22,23
Gears, countershaft	15	Switch, safety-start	21,22,23
Gears, drive	14	T	
Guard, chute, with decals	16	Tire, front	11
H		Tire, rear	12
Harness, wiring, main	21,22,23	Traction drive belt	5,6
Harness, wiring, mower motors	25,26	Traction motor	24
Hold-down, battery	18	Transaxle gear case assembly	13
Housing, shift lever	9	W	
Housing, transaxle	13	Wheel, front	11
Hub, rear wheel	12	Wheel, gauge, mower	16
I		Wheel, rear	12
Idler, reverse	14	Wheel, steering	11
Input, shaft	13	Wiring harness, main	21,22,23
K		Wiring harness, mower motors	25,26
Kit, receptacle, remote, electric	21,22,23		

FRAME, BATTERY BOX, AND CONSOLE

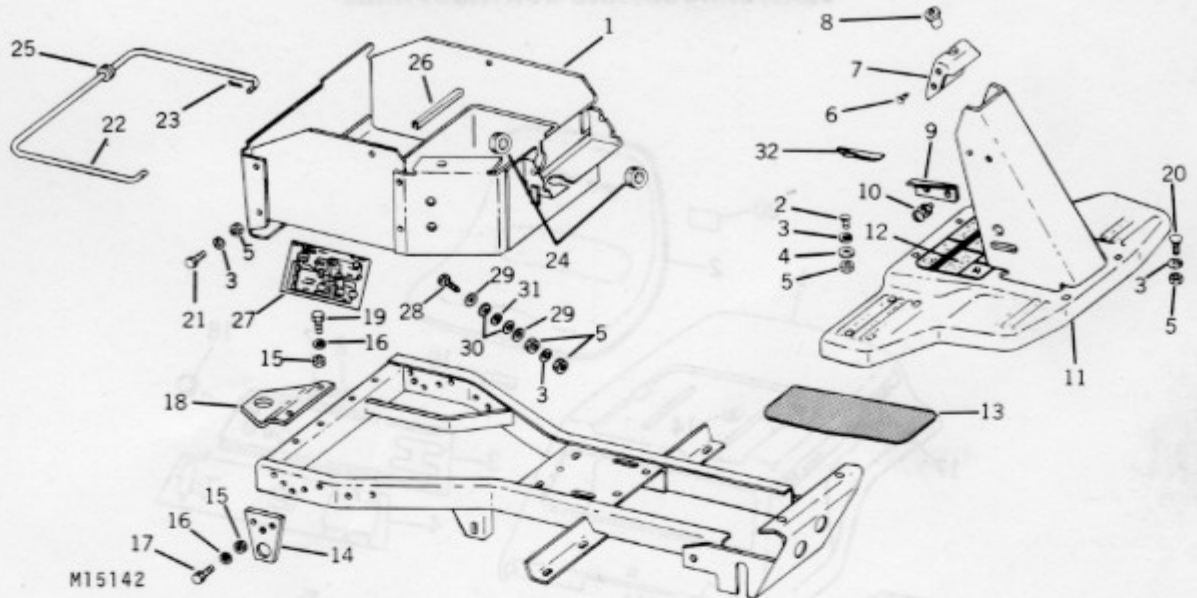

Key	Part No.	Serial No.	Description
1	AM 33914	(- 10000)	Box, battery
	AM 34658	(10001 - 11704)	Box, battery
	AM 35274	(11705 -)	Box, battery
2	3H 1268	(-)	Bolt, cge., 5/16" x 3/4" (4 used)
3	12H 303	(-)	Washer, lock, 5/16" (17 used)
4	24H 1136	(-)	Washer, 11/32" x 11/16" x .060" (8 used)
5	14H 785	(-)	Nut, 5/16" (19 used)
6	37H 126	(-)	Screw, self-tapping, No. 8 x 3/8" (3 used)
7	M 46433	(-)	Cap, console
8	M 45262	(-)	Bushing, plastic
9	M 46440	(- 11704)	Latch, lever
	M 48417	(11705 -)	Latch, lever
10	21H 1302	(-)	Screw, mach., 1/4" x 5/8" (2 used)
	12H 302	(-)	Washer, lock, 1/4"
11	AM 33978	(-)	Console
12	M 46519	(- 10000)	Label, instruction
	M 47426	(10001 -)	Label, instruction
13	AM 33750	(-)	Kit, foot-tread (includes R.H. and L.H. treads)
14	M 46385	(-)	Support, axle, rear
15	14H 812	(-)	Nut, 3/8" (6 used)
16	12H 304	(-)	Washer, lock, 3/8" (6 used)
17	19H 1936	(-)	Screw, cap, 3/8" (6 used)
18	M 46437	(-)	Plate, hitch
19	19H 1731	(-)	Screw, cap, 3/8" x 1" (2 used)
20	3H 1539	(-)	Bolt, cge., 5/16" x 5/8" (2 used)
21	19H 1813	(-)	Screw, cap, 5/16" x 5/8" (5 used)
22	M 46442	(-)	Rod, support, shroud
23	11H 206	(-)	Pin, cotter, 3/32" x 3/4" (2 used)
24	H 23197	(- 1500)	Grommet (2 used)
	M 44391	(1501 -)	Edging, vinyl (10 ft. long) (cut as required)
25	M 46796	(1501 -)	Grommet (2 used) (sub. for M46492)
26	M 44391	(-)	Edging, vinyl (10 ft. long) (cut as required)
27	M 47447	(10001 - 11704)	Decal, electric system
	M 48727	(11705 -)	Decal, electric system
28	19H 1905	(11705 -)	Screw, cap, 5/16" x 1" (2 used)
29	24H 1224	(11705 -)	Washer, 11/32" x 1" x .060" (4 used)
30	M 41394	(11705 -)	Washer, fiber, 11/32" x 1" x .060" (4 used)
31	M 41393	(11705 -)	Washer, fiber, 11/32" x 41/64" x .060" (2 used)
32	M 48418	(11705 -)	Decal, cutting height
..	..	(-)	Frame (dealer contact branch service department when required)
..	AM 35067	(-)	Kit, French and English decal

