

# INSTALLATION INSTRUCTIONS FOR FUEL

## GAGE KIT. PART NO. 120626

**WARNING:** Remove battery clamp terminating wire 2-01 from the positive post of battery B2 and replace the battery cover before proceeding with this installation. Do not lower the control panel on to the exposed battery terminals.

1. Lower the upper control panel so its mounted components are exposed as shown in Figure 1.

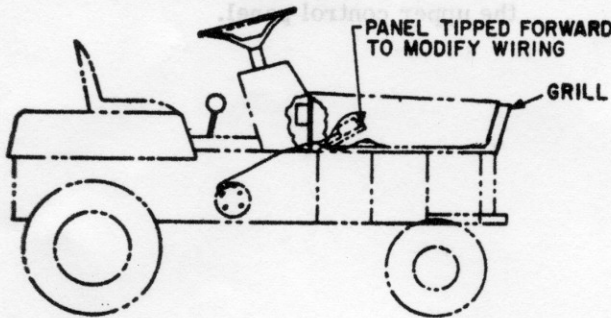

Figure 1

2. Disconnect plug P3 from jack J3 which joins the control cabinet wiring to the control panel wiring. See Figure 2.

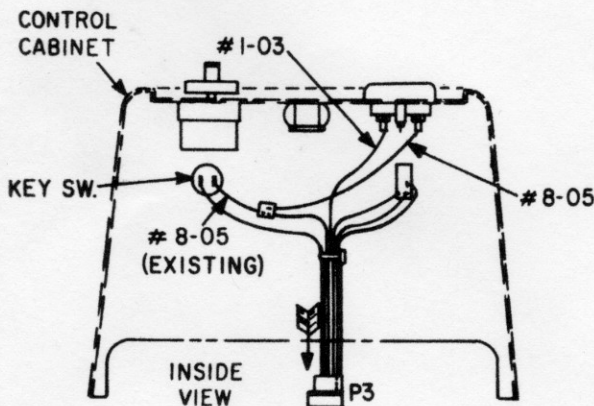

Figure 2

3. Place the supplied template just inside the raised edge of the top surface of the control cabinet as shown in Figure 3.

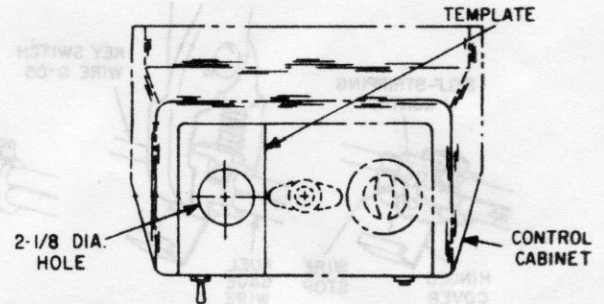

Figure 3

4. Using a pencil or scribe, draw the outline of the 2-1/8 inch diameter hole using the template as a guide. If necessary, determine the center of this hole by laying a straight edge across opposite pairs of registration marks on the circumference of the template and drawing a line where it crosses the hole's center.

**CAUTION:** Move any wiring that may be located behind the cabinet in the area where the hole is to be placed.

5. Cut the 2-1/8 inch diameter hole in the control cabinet using the drawn outline as a guide.
6. Remove the mounting bracket from the fuel level gage and seat the gage in the 2-1/8 inch hole. Straighten the gage and secure it with the mounting bracket and nuts assembled from the inside of the cabinet as shown in Figure 4.



Figure 4

7. Attach the barrel terminal end of wire 8-05 (furnished) to the fuel level gage terminal closest to the left side of the tractor (clutch/brake pedal side).
8. Locate wire 8-05 which connects one terminal of the key switch with plug P3 position 5. In-

sert the free end of wire 8-05 (just installed) to the stop in the hinged side of the self-stripping U-connector while the key switch wire 8-05 lays in the other groove of the connector. Squeeze the connector metal clip with pliers before closing the cover. Close cover around the connector until it latches. See Figure 2 and 5. Avoid installation in low temperatures, as the U-connector may crack on sudden closure.

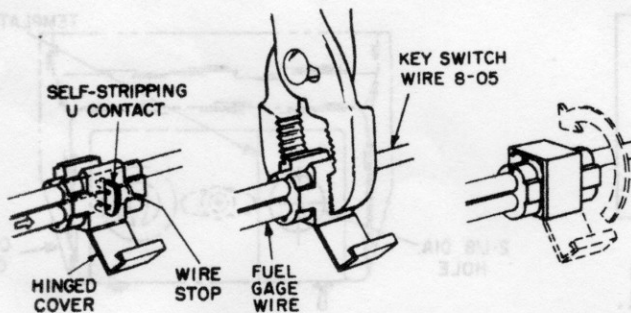

Figure 5

9. Insert the pin end of wire 1-03 (furnished) into plug P3 position 6. See Figure 7A. Make sure the pin locks into the plug housing.
10. Attach the barrel terminal end of this wire to the vacant fuel level gage terminal.

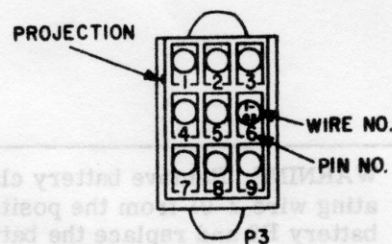

Figure 6

11. Reconnect plug P3 with jack J3 and recheck all wiring and connections for correctness and tightness.
12. Replace the battery clamp on B2+ and close the upper control panel.

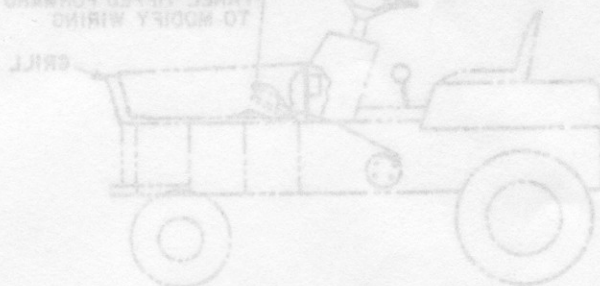

Figure 1

1. Disconnect plug P3 from jack J3 which joins the control cabinet wiring to the control panel wiring. See Figure 2.

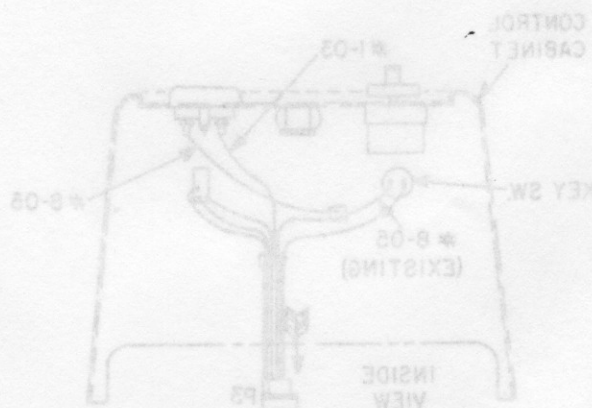

Figure 2

2. Place the supplied template just inside the raised edge of the top surface of the control cabinet as shown in Figure 3.