

When Ordering Parts Give:

1. Part Number
2. Part Name
3. Model Number

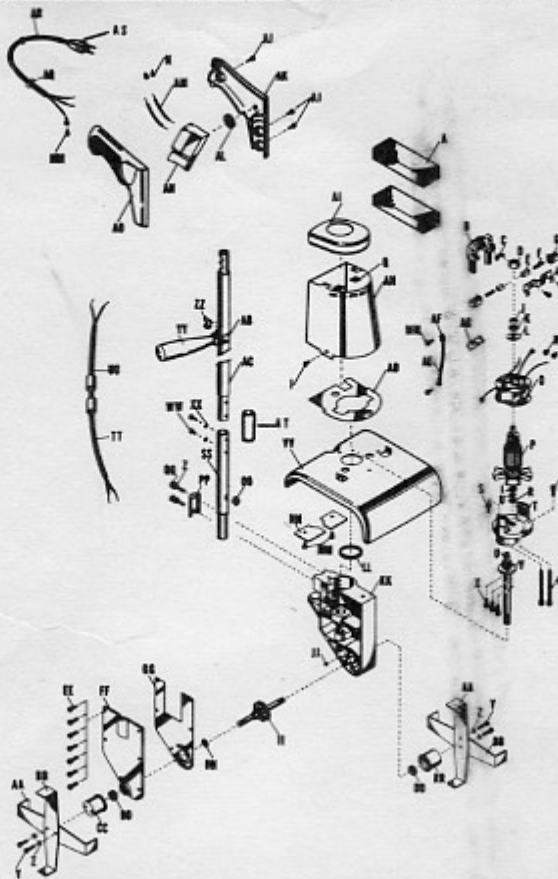

PARTS LIST

REF. LTR.	PART NO.	DESCRIPTION	REF. LTR.	PART NO.	DESCRIPTION
A	01-01525	Filter	II	S-01-01528	Drive Shaft
B	06-00474	Stator Bracket	JJ	10-00060	Ball
C	01-00452	Oil Felt	KK	S-06-00911*	Drive Housing Assembly (Includes Drive Shaft Bearing 9-20 and Motor Shaft Bearing 9-59)
D	09-00044	Bronze Bearing	LL	17-00304	Felt Washer
E	14-00094	Carbon Brush	MM	22-00594	Screw
F	14-00068	Brush Spring	NN	43-00378	Dust Shield
G	14-00045	Brush Holder	PP	43-00398*	Clamp
H	27-00054	Spring, Brush Holder & Bearing	QQ	22-00476	Screw
I	22-00713	Screw	RR	06-00909	Adapter
J	27-00008	Loading Spring	SS	43-00363	Handle, Lower Half
K	17-00313	Fibre Washer	TT	11-00090B	Cord Set
L	17-00100	Fibre Washer	UU	11-00088B	Cord Set
N	16-00004	Connector	VV	43-00364*	Upper Guard
O	08-00222	Field Assembly	WW	22-00616	Screw
P	07-00217	Armature Assembly	XX	17-00086	Lock Washer
Q	22-00586	Speed Nut	YY	AH-00-00022B	Handle
R	17-00101	Fibre Washer	ZZ	43-00394	Bridge
S	22-00158	Screw	AB	43-00400	Strap
T	S-06-00478	Gear Box Assembly	AC	43-00497	Handle, Upper Half
U	17-00090	Steel Washer	AD	01-00932	Bottom Baffle
V	S-03-00525	Motor Shaft Assembly	AG	23-00115	Tape
W	22-00089	Screw	AH	43-00374*	Motor Housing
X	22-00387	Screw	AI	05-00948	Cap
Y	22-00560	Screw	AJ	22-00676	Screw
Z	17-00181	Lock Washer	AK	44-00229	Handle Support
AA	43-00359	Blade	AL	28-00095	Rubber Pad
BB	43-00358	Blade	AN	18-00253	Switch
CC	06-00910	Adapter	AO	44-00230	Handle Cover
DD	17-00208	Washer	AR	11-00225	Cord Set
EE	22-00474	Screw	AS	11-00226	Plug
FF	S-06-00476*	Cover	AT	23-00272	Insulator
GG	17-00411	Gasket			
HH	17-00005	Steel Washer			