

# GENERAL ELECTRIC

OUTDOOR  
POWER EQUIPMENT  
OPERATION

GENERAL ELECTRIC COMPANY, CORPORATIONS PARK, BUILDING 702,  
SCHENECTADY, NEW YORK 12345, Phone (518) 374-2211

January 3, 1974

TO: ELEC-TRAK TRACTOR DEALERS

## PARTS BOOK INFORMATION - SNOW THROWER

INSERT THE ATTACHED FIGURES 16-12 AND 16-16 IN YOUR ELEC-TRAK PARTS BOOK UNDER THE "ACCESSORY" TAB.

### CHANGES:

Figure 16-12: Stack drive parts may be ordered as assembly as shown by ordering Part No. 247A7790G1.

Figure 16-16: Lift mounting parts may be ordered as assembly as shown by ordering 247A7791G1.

These should be ordered direct from your local Elec-Trak parts distributor.

Sincerely,

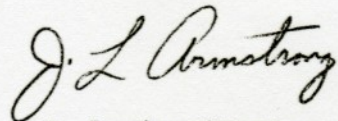

J. L. Armstrong,  
Manager - Dealer Services

JLA/lba

Attachments





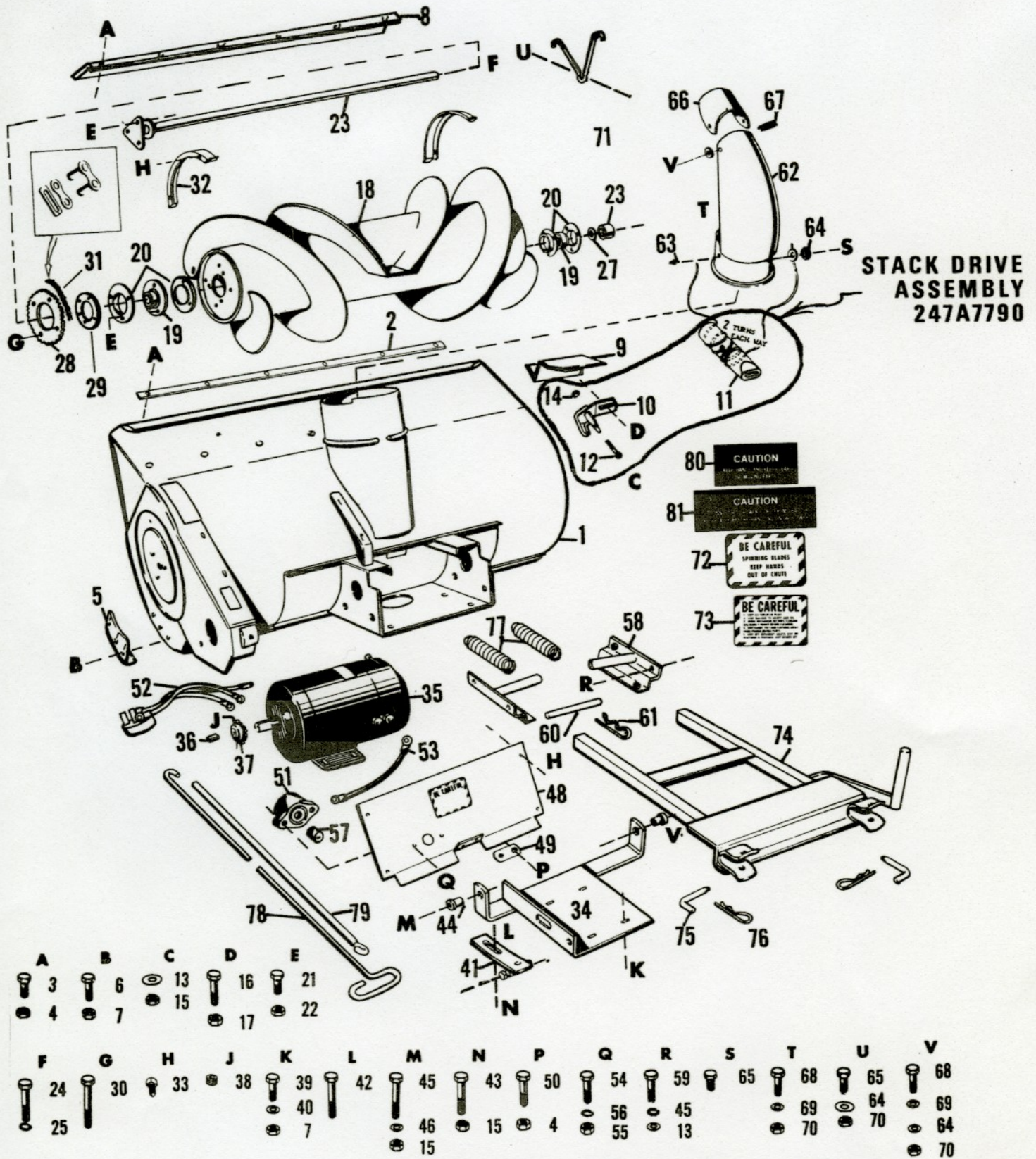

REFERENCE NUMBER IS THE NUMBER ON THE DRAWING PRECEDED BY "AD"

Fig. AC-5

16-12

**SNOW THROWER MODEL AD 42AA**

